

21215 & 21255 BURBANK BLVD., WOODLAND HILLS, CA

for lease



ACCESSIBLE
CONVENIENT
PREMIER
PROMINENT
CORPORATE

Property Highlights

- Newest Class "A" office space in Warner Center
- On-site retail amenities
- Highly efficient floor plates
- Conveniently located at the northeast corner of Canoga Avenue and Burbank Boulevard
- Excellent access to the 101 Freeway
- Prominent identification and impact signage

For more information, please contact:

Dan Sanchez
Lic. 01308273
+1 818 531 9682 Office
dan.sanchez@am.jll.com



21255 Burbank | Availability

Suite	Size	Rate	Available
*100	5,260 SF	\$2.75 FSG	Immediately
120	6,944 SF	\$2.75 FSG	Immediately
*140	2,718 SF	\$2.75 FSG	90 days
*200	1,630 SF	\$2.75 FSG	Immediately
*250	7,638 SF	\$2.75 FSG	Immediately
*270	9,603 SF	\$2.75 FSG	Immediately
290	3,430 SF	\$2.75 FSG	Immediately
300	8,775 SF	\$2.75 FSG	Immediately

* Suite 100 & 140 Contiguous to 7,978 RSF

* Suite 200, 250 & 270 Contiguous to 18,871 RSF

21215 Burbank | Availability

Suite	Size	Rate	Available
5 th Floor	30,108 SF	\$2.75 FSG	Immediately
6 th Floor	2,915 SF	\$2.75 FSG	Immediately



For more information, please contact:

Dan Sanchez
 Lic. 01308273
 +1 818 531 9682 Office
 dan.sanchez@am.jll.com



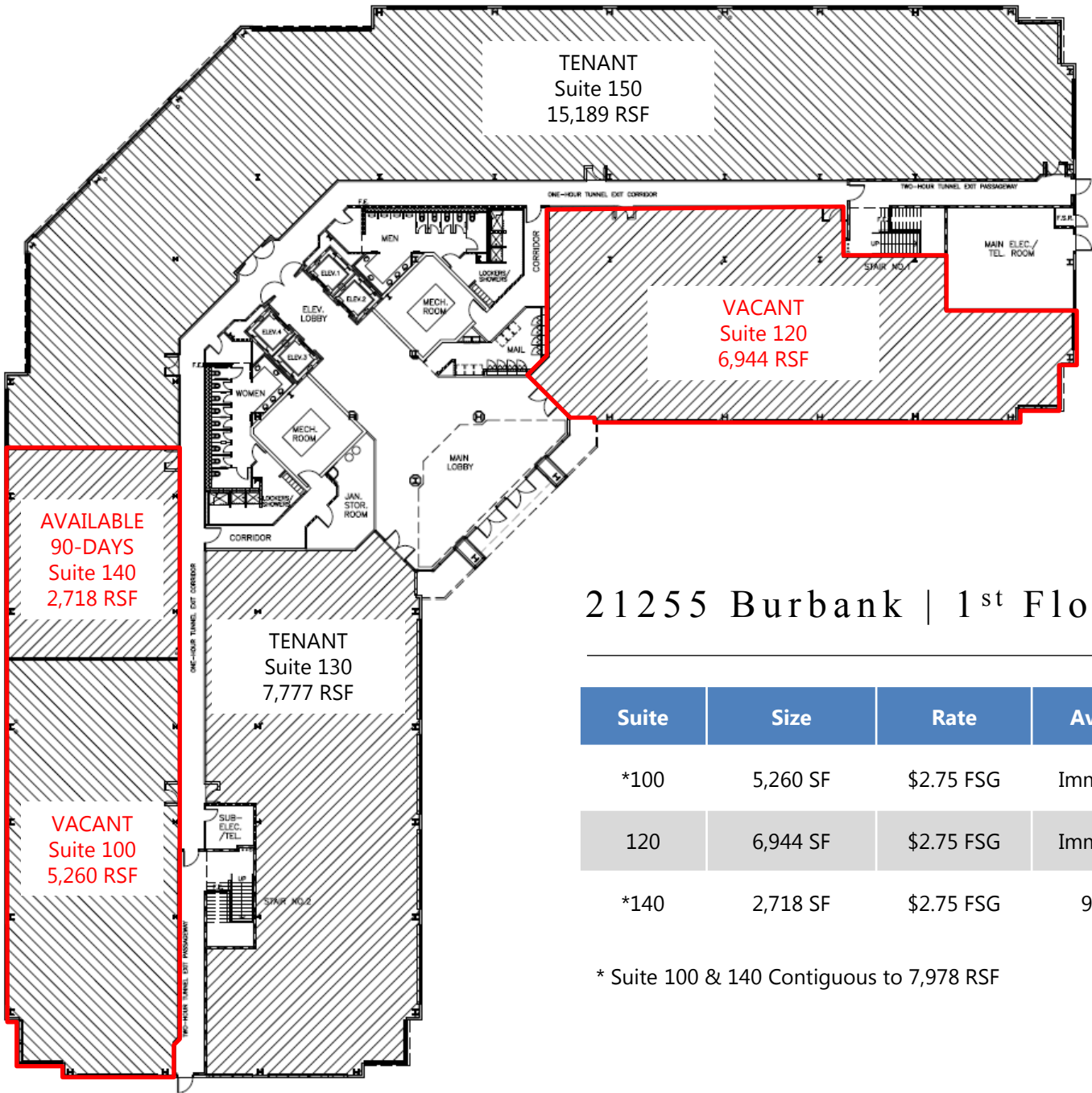

21255 Burbank | 1st Floor

Suite	Size	Rate	Available
*100	5,260 SF	\$2.75 FSG	Immediately
120	6,944 SF	\$2.75 FSG	Immediately
*140	2,718 SF	\$2.75 FSG	90 days

* Suite 100 & 140 Contiguous to 7,978 RSF

For more information, please contact:

Dan Sanchez
 Lic. 01308273
 +1 818 531 9682 Office
 dan.sanchez@amjll.com



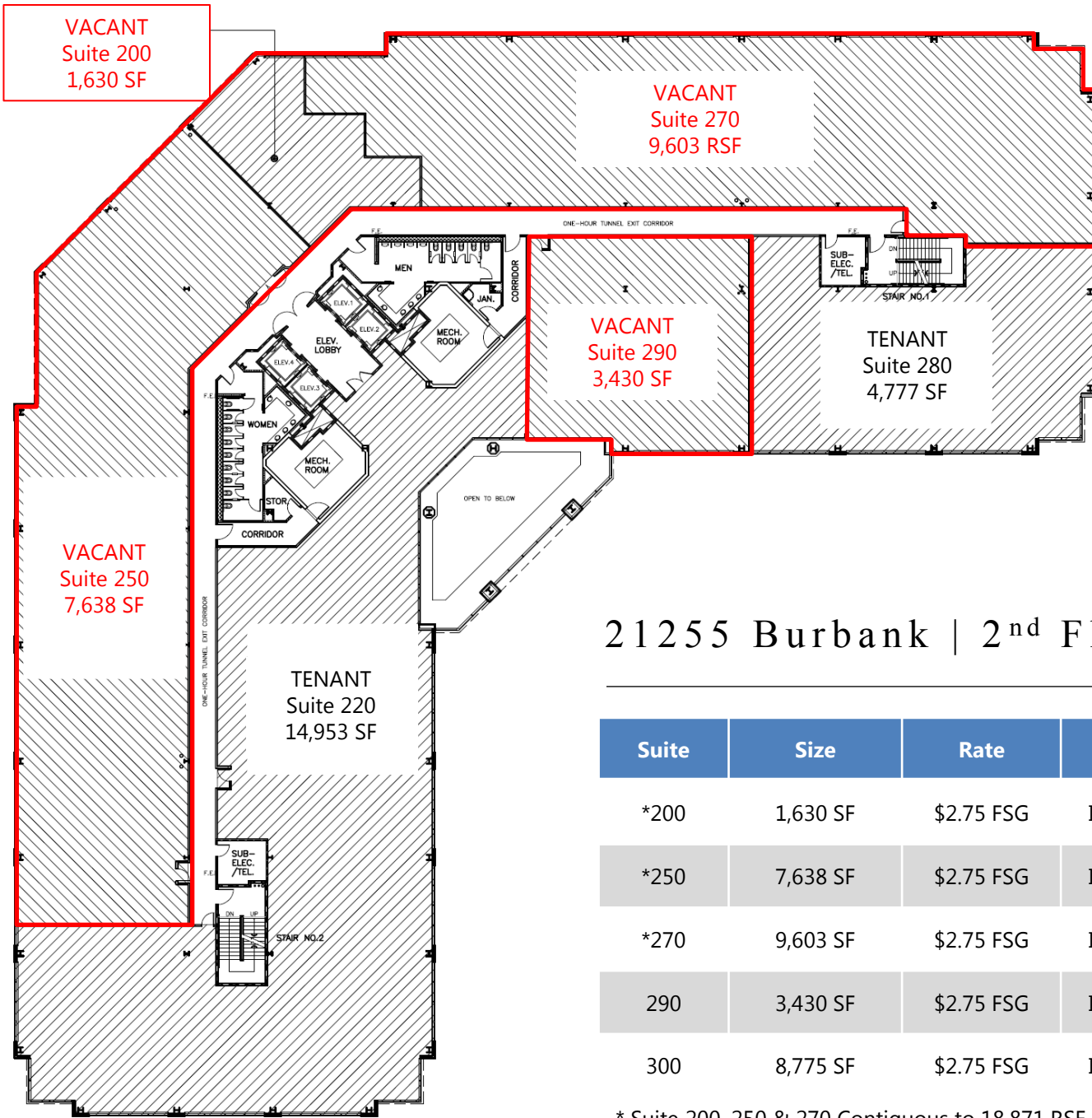

21255 Burbank | 2nd Floor

Suite	Size	Rate	Available
*200	1,630 SF	\$2.75 FSG	Immediately
*250	7,638 SF	\$2.75 FSG	Immediately
*270	9,603 SF	\$2.75 FSG	Immediately
290	3,430 SF	\$2.75 FSG	Immediately
300	8,775 SF	\$2.75 FSG	Immediately

* Suite 200, 250 & 270 Contiguous to 18,871 RSF

For more information, please contact:

Dan Sanchez
 Lic. 01308273
 +1 818 531 9682 Office
 dan.sanchez@amjll.com



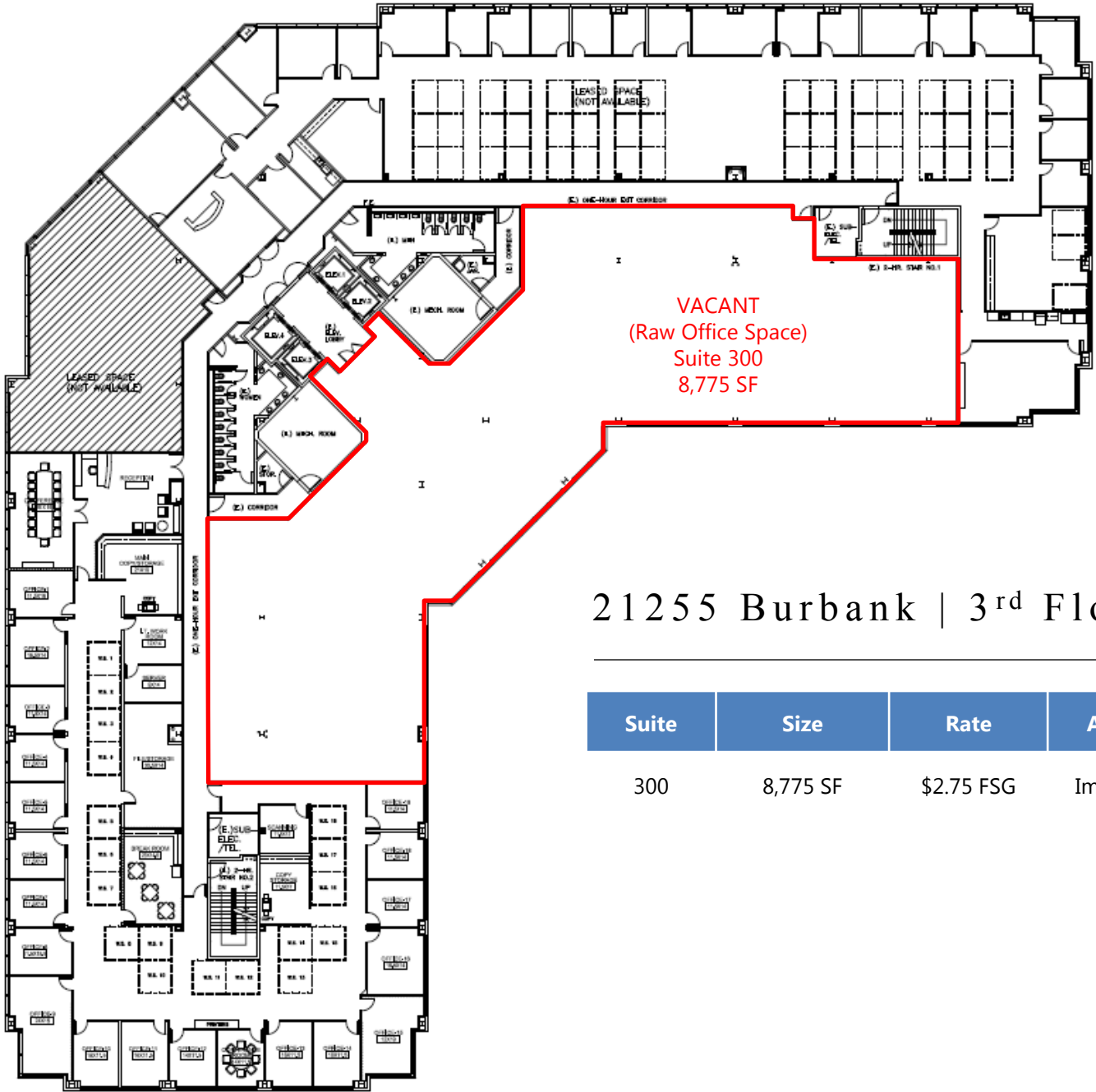

21255 Burbank | 3rd Floor

Suite	Size	Rate	Available
300	8,775 SF	\$2.75 FSG	Immediately

For more information, please contact:

Dan Sanchez
 Lic. 01308273
 +1 818 531 9682 Office
 dan.sanchez@amjll.com



21215 Burbank | 5th Floor

Suite	Size	Rate	Available
5 th Floor	30,108 SF	\$2.75 FSG	Immediately

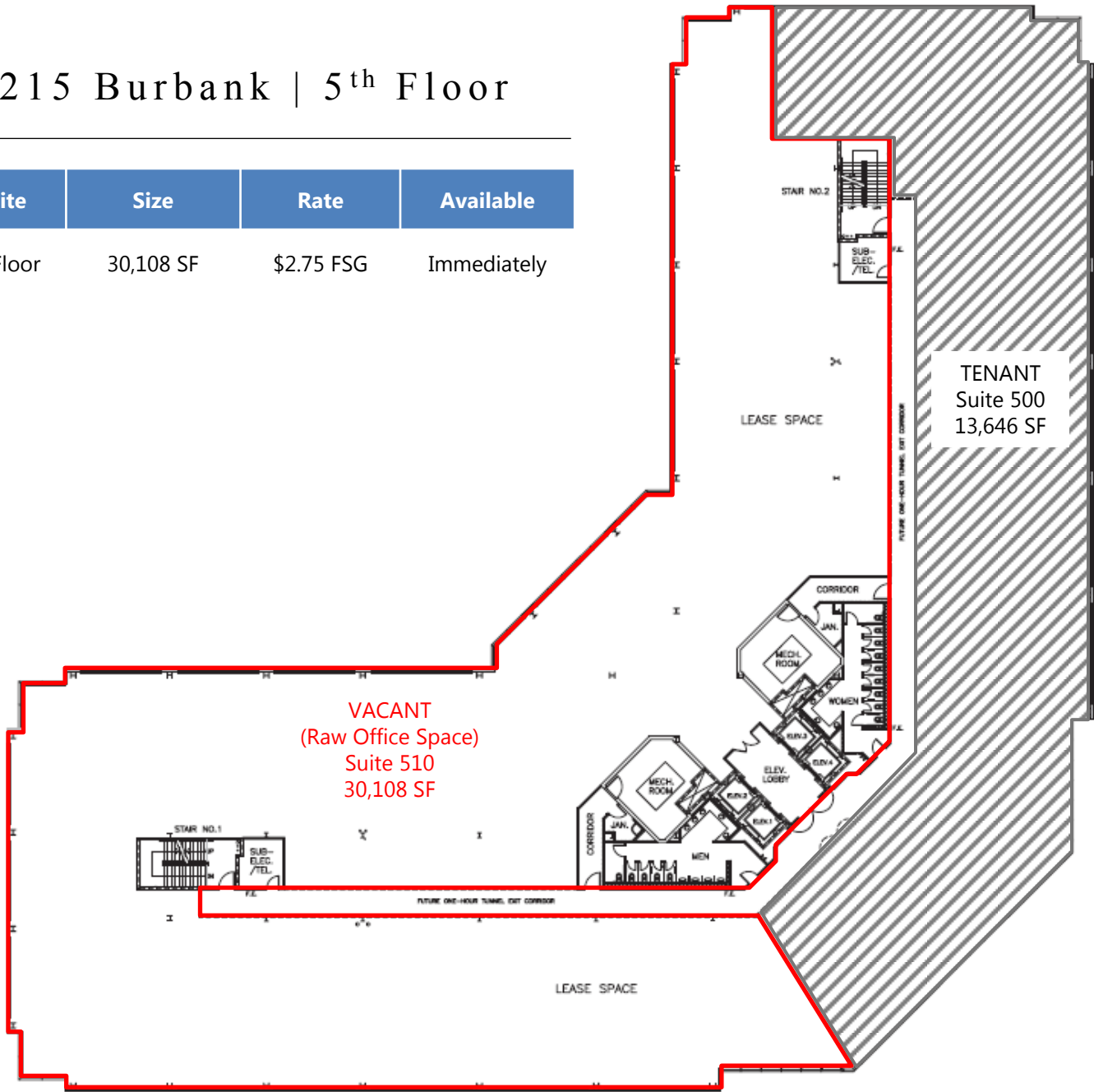

For more information, please contact:

Dan Sanchez
Lic. 01308273
+1 818 531 9682 Office
dan.sanchez@amjll.com



21215 Burbank | 6th Floor

Suite	Size	Rate	Available
6 th Floor	2,915 SF	\$2.75 FSG	Immediately

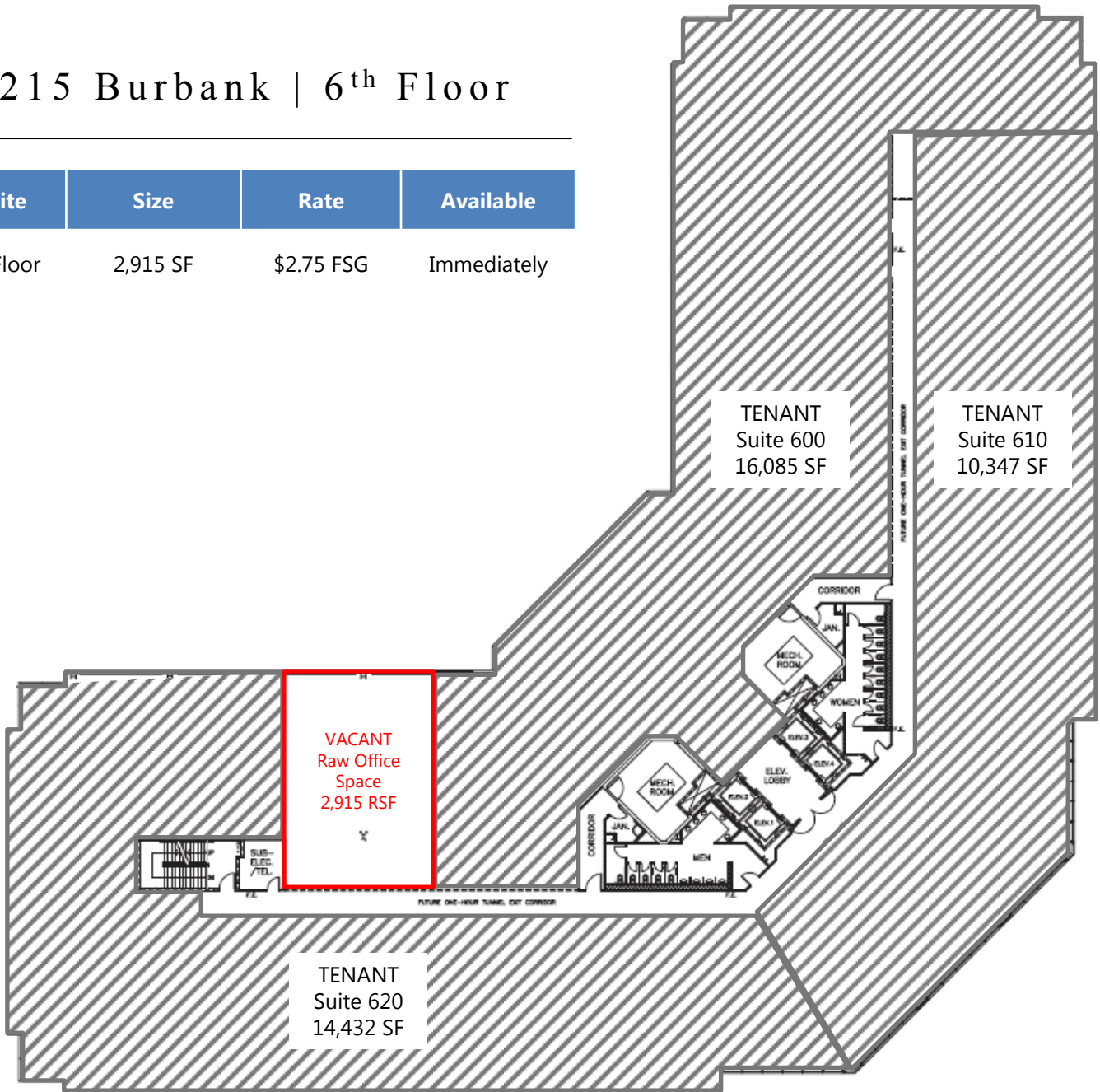

For more information, please contact:

Dan Sanchez
Lic. 01308273
+1 818 531 9682 Office
dan.sanchez@am.jll.com

